

K40 Mk2 & K20 Mk2 Foam/Water Sprinklers

Air Aspirating, Open, Foam/Water Nozzles for Flammable Liquids Fire Protection

- Gentle uniform foam sprinkler applications
- Pendant orientation, 5 to 7:1 expansion
- Compact, reliable robust units
- Exceptional corrosion resistance



Angus K40 and K20 Foam/Water, air aspirating, nozzles now in improved Mk2 versions, are designed for use as part of an engineered fire protection system.

Each sprinkler, designed for mounting in the pendant position, produces a uniform solid cone discharge pattern (as detailed overleaf), delivering very similar spray patterns for both foam and water. The fire protection system can therefore be designed in accordance with NFPA 11/16, to deliver an initial foam discharge to combat flammable liquid fires, followed by a period of water discharge, providing additional structural cooling as required, reducing the risk of re-ignition.

The K40 Mk2 is designed to meet 6.5 litres/m²/min application rates under NFPA spacing requirements, whilst the K20 Mk2 is designed for applications requiring 4.1 litres/m²/min. These well tried and tested foam/water sprinklers are installed worldwide across a wide range of foam applications.

Popular applications include process area protection, road and rail tanker loading bays, warehousing, pipe racks, even aircraft hangars. They are particularly well suited for use in high risk situations where mixed risk flammable liquids are stored. When used in conjunction with Angus fluorinated or fluorine-free AR (Alcohol Resistant) foam concentrate both K40 Mk2 and K20 Mk2 provide excellent quality of finished foam, sealing off vapours and protecting against reignition.

Both these foam/water sprinklers are compact, robust and consequently less easily damaged than conventional designs. Each sprinkler is entirely constructed from 316 stainless steel, providing excellent corrosion resistance, making them particularly well suited to process area and coastal applications.

Both units are designed to produce foam with expansion ratios in the range 5:1 to 7:1 over their 1 - 7 bar.

(15 - 100 psi) operating range.

Flow (litres/min) = $K\sqrt{P}$ where P is inlet pressure (bar)

Approvals

K40 Mk2 & K20 Mk2

Lloyds Register of Shipping

Maritime and Coastguard Agency

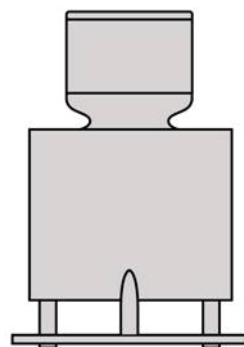

K40 Mk2

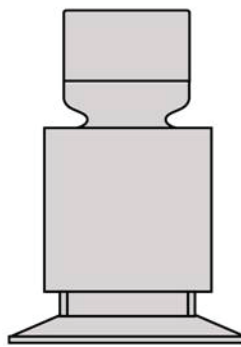

K20 Mk2

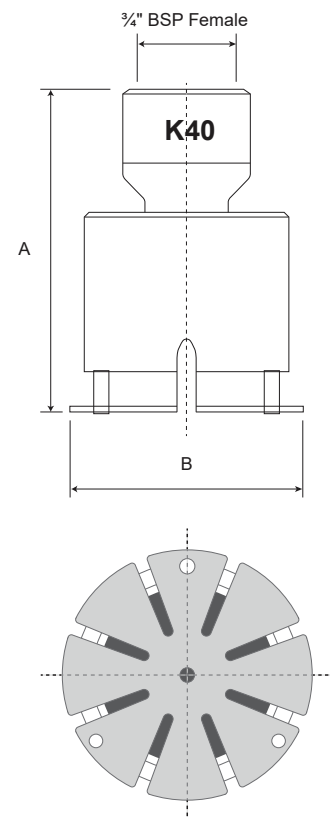

K40 Mk2 & K20 Mk2 Foam/Water Sprinklers

Air Aspirating, Open, Foam/Water Nozzles for Flammable Liquids Fire Protection

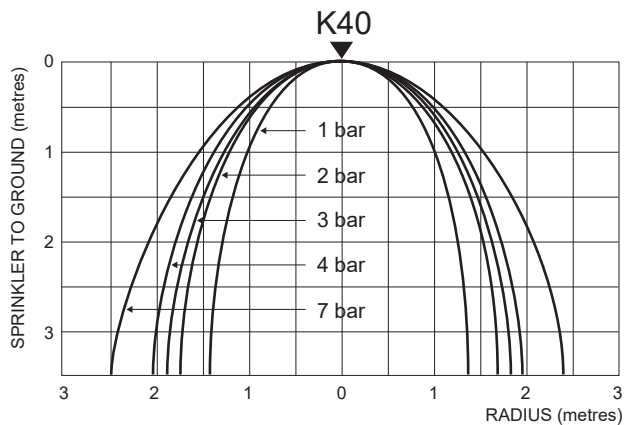

Typical print diameter = 3.9 metres at 4 bar.g. when mounted 2.5 metres above ground

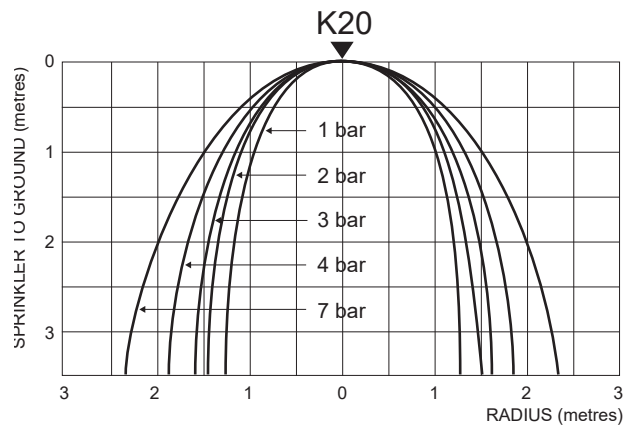

Typical print diameter = 3.5 metres at 4 bar when mounted 2.5 metres above ground

DIMENSIONS (nominal)		
Foam/Water Sprinklers	K40 Mk2	K20 Mk2
A (mm)	87.7	87.7
B (mm)	61 (diameter)	48 (diameter)
Inlet connection	¾" BSP Female	¾" BSP Female
Approx. weight	0.41 Kg	0.36 Kg

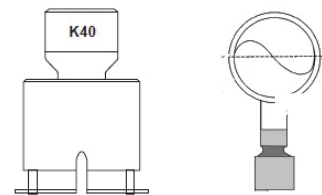

Angus Fire foam/water stainless steel open spray nozzle
Mounting orientation of pendant K40/K20 Nozzles